

For Details of Roof
Construction see Drg Nos.
C21/06; 08

For Eaves Details see
Drg Nos. A21/204; 208;
212, C/20/07

For Window Opening
Details see A31 series
drawings

For Details of Lattice Joists
to External Walls see A23
series of drawings C/21/09

For Details at Ground
Level see Drg
Nos. A/21/201; 205; 209

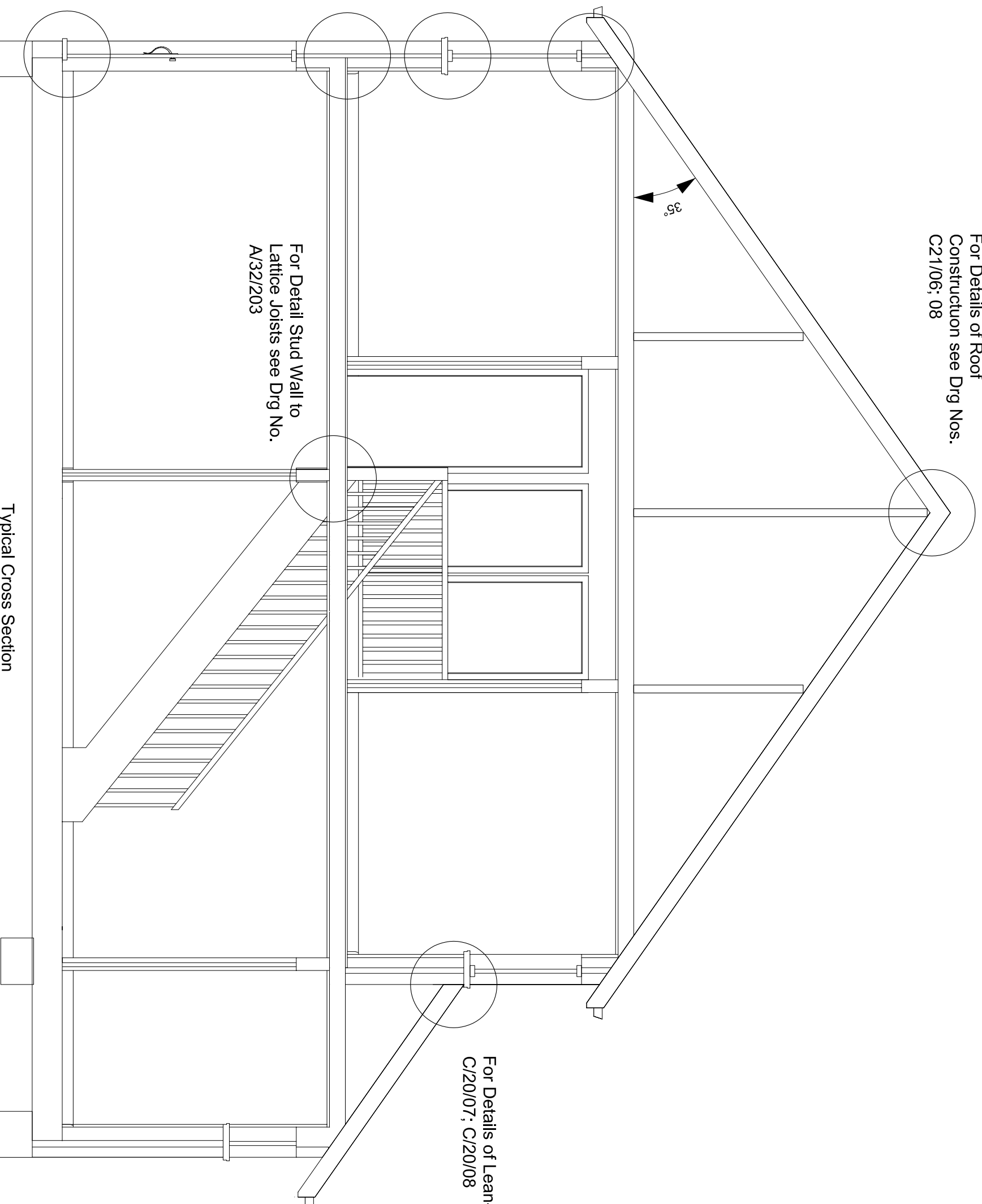

Typical Cross Section

For Detail Stud Wall to
Lattice Joists see Drg No.
A/32/203

For Details of Lean-To Roof see Drg Nos.
C/20/07; C/20/08

NOTES

IMPORTANT: ALL COPYRIGHT AND DESIGN RIGHT, SUBSISTING IN THIS DOCUMENT IS THE PROPERTY OF SCOTTSDALE CONSTRUCTION SYSTEMS AND ASSOCIATED COMPANIES AND MAY NOT BE REPRODUCED WITHOUT WRITTEN CONSENT. THIS DOCUMENT AND THE INFORMATION CONTAINED WITHIN IT, IS CONFIDENTIAL TO SCOTTSDALE CONSTRUCTION SYSTEMS AND ASSOCIATED COMPANIES AND MAY NOT BE DISCLOSED TO ANY THIRD PARTY WITHOUT WRITTEN CONSENT.

REVISIONS

NO.	DESCRIPTION

UNLESS OTHERWISE
STATED ALL
DIMENSIONS ARE IN
MILLIMETRES

DO NOT SCALE

IF IN DOUBT ASK!

PROJECT NAME 2 Storey Model House Construction Details

CUSTOMER NAME Scottsdale Steel UK Ltd

DRAWING TITLE Typical Cross Section

SCALE N.T.S.

STATUS

Scottsdale Steel UK Ltd
500 Chiswick High Road, London W4 5RG

DRAWING No. **IS/202**

CHECKED BY: Serdar Dundar

REVISION -

DATE

Scottsdale
Scottsdale Construction Systems

Bob Colver
10-06-06

